

Soils Map

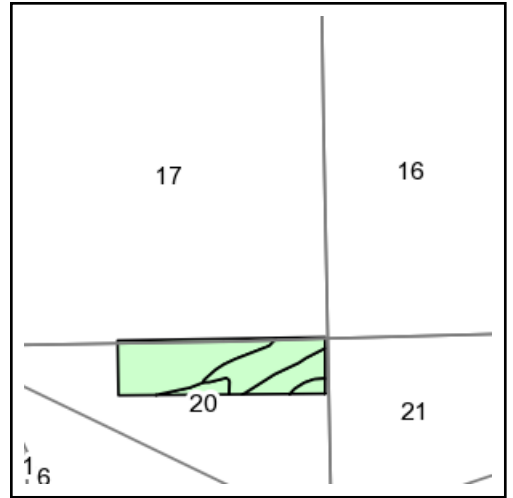
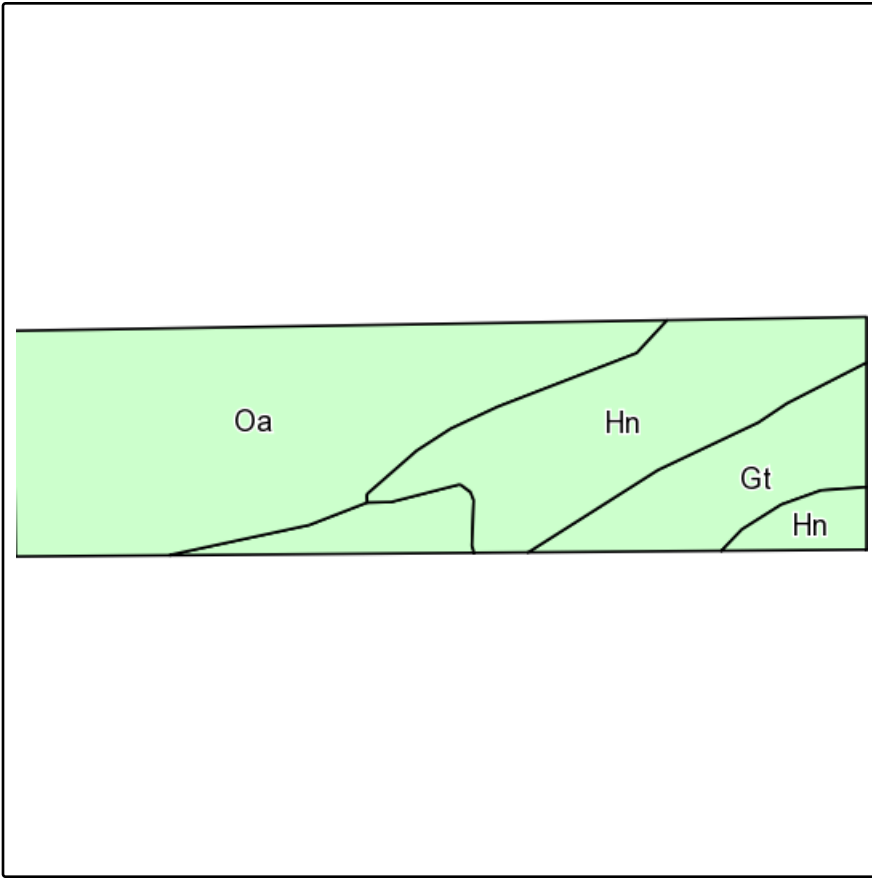

State: **South Dakota**
 County: **Clay**
 Location: **17-92N-53W**
 Township: **Norway**
 Acres: **40.39**
 Date: **9/10/2013**

**BURLAGE
 PETERSON
 REALTY**
 Auctioneers & Realtors

Maps provided by:

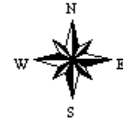

©AgriData, Inc 2013
 www.AgriDataInc.com

Field borders provided by Farm Service Agency as of 5/21/2008.
 Soils data provided by USDA and NRCS.

| Code | Soil Description | Acres | Percent of field | Non-Irr Class | Irr Class | Productivity Index |
|-------------------------|--|-------|------------------|---------------|-----------|--------------------|
| Oa | Onawa silty clay, 0 to 2 percent slopes | 20.70 | 51.3% | Ils | | 85 |
| Hn | Haynie-Lossing-Grable complex, 0 to 2 percent slopes | 12.00 | 29.7% | Is | I | 83 |
| Gt | Grable-Ticonic-Vore complex, 0 to 2 percent slopes | 7.69 | 19.0% | Ils | | 60 |
| Weighted Average | | | | | | 79.6 |