

# Soils Map

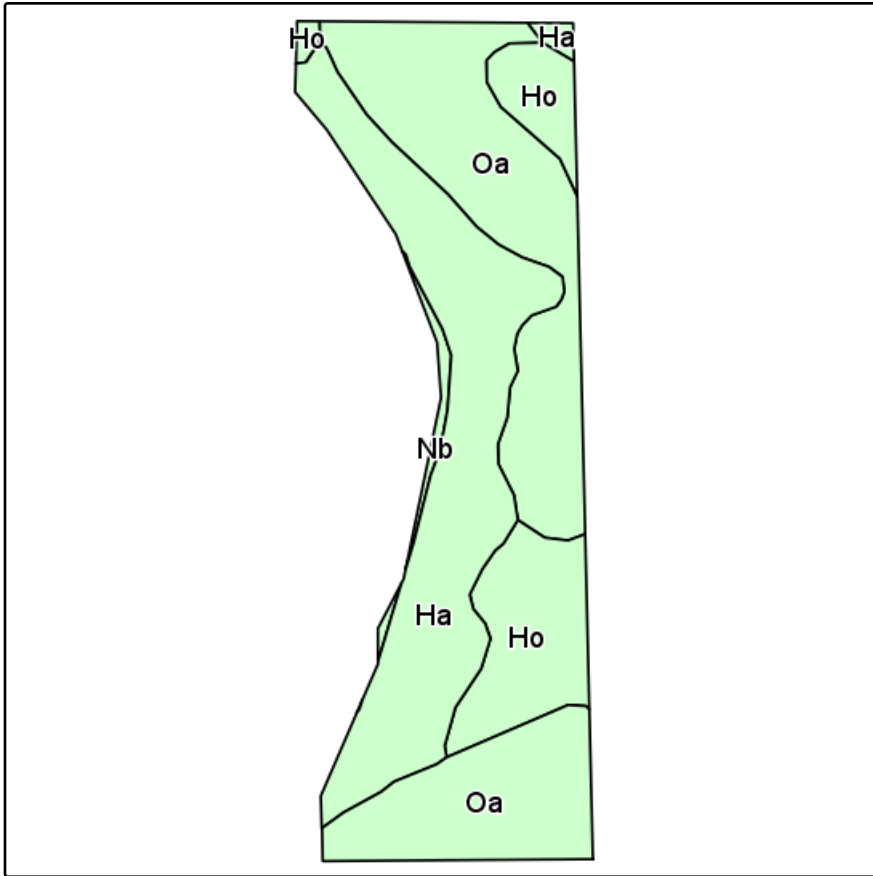

Field borders provided by Farm Service Agency as of 5/21/2008.  
Soils data provided by USDA and NRCS.

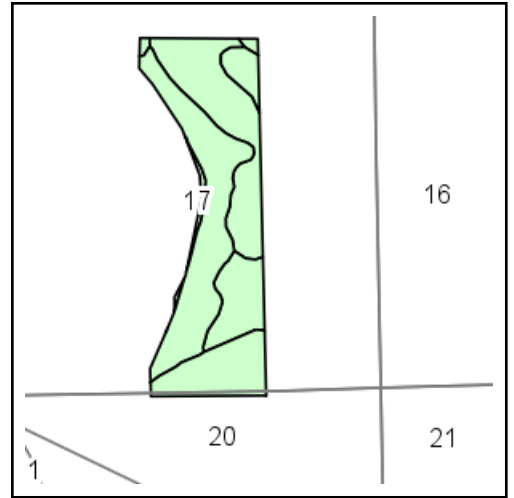

State: **South Dakota**  
County: **Clay**  
Location: **17-92N-53W**  
Township: **Norway**  
Acres: **92.20**  
Date: **10/14/2013**

**BURLAGE  
PETERSON  
REALTY**  
Auctioneers & Realtors

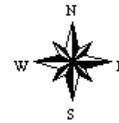

Maps provided by:



Code	Soil Description	Acres	Percent of field	Non-Irr Class	Irr Class	Productivity Index
Oa	Onawa silty clay, 0 to 2 percent slopes	41.58	45.1%		Ils	85
Ha	Haynie silt loam, 0 to 2 percent slopes	33.48	36.3%		I	89
Ho	Haynie-Onawa-Blake complex, 0 to 2 percent slopes	15.80	17.1%		Is	88
Nb	Norway loamy fine sand, 0 to 4 percent slopes	1.34	1.5%		VIIIw	9
<b>Weighted Average</b>						<b>85.9</b>