

Soils Map

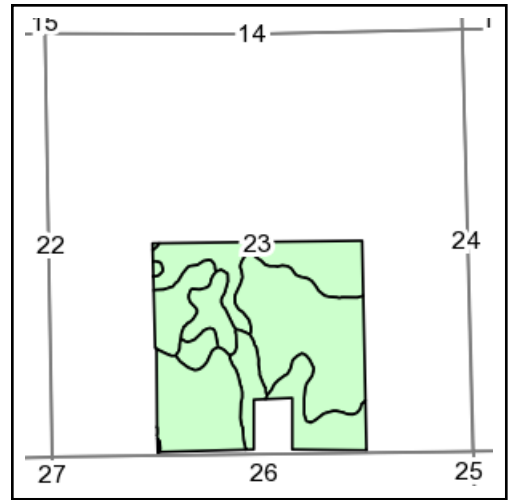
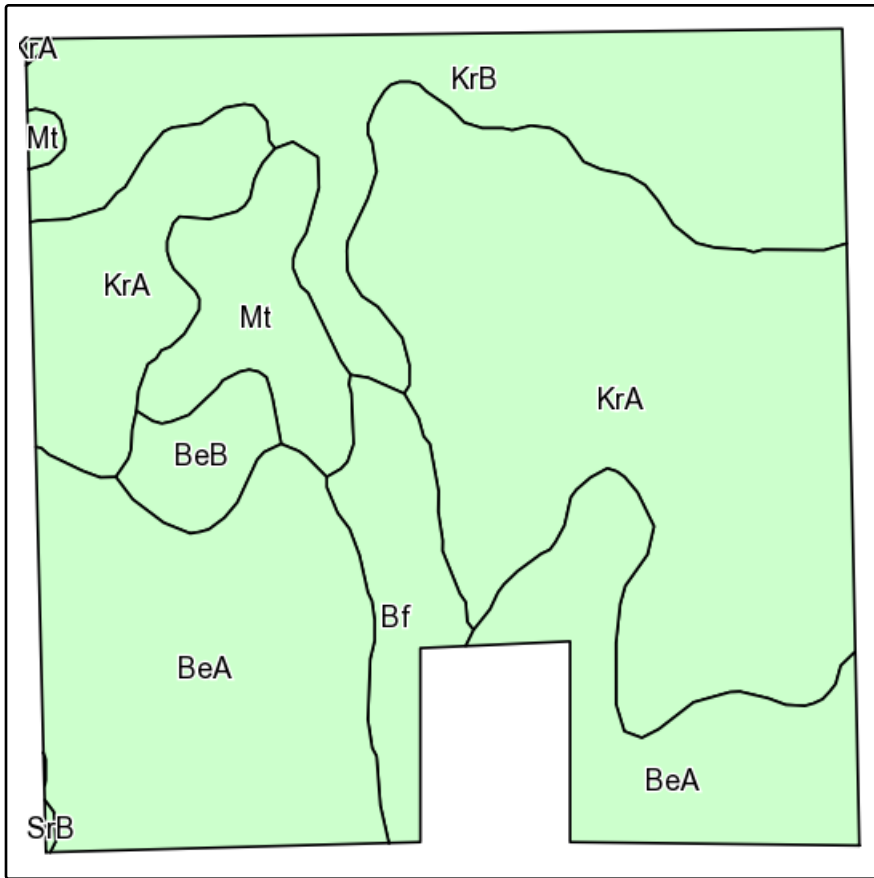

State: **South Dakota**
 County: **Brookings**
 Location: **23-111N-50W**
 Township: **Sterling**
 Acres: **150.92**
 Date: **9/17/2013**

**BURLAGE
 PETERSON
 REALTY**
 Auctioneers & Realtors

Maps provided by:

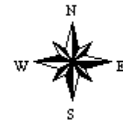

©AgriData, Inc 2013
www.AgriDataInc.com

Field borders provided by Farm Service Agency as of 5/21/2008.
Soils data provided by USDA and NRCS.

Code	Soil Description	Acres	Percent of field	Non-Irr Class	Productivity Index
KrA	Kranzburg-Brookings silty clay loams, 0 to 2 percent slopes	58.95	39.1%	I	91
BeA	Brandt silty clay loam, 0 to 2 percent slopes	42.62	28.2%	I	86
KrB	Kranzburg-Brookings silty clay loams, 1 to 6 percent slopes	28.92	19.2%	Ile	87
Mt	McIntosh-Badger silty clay loams, 0 to 2 percent slopes	8.94	5.9%	Ilw	81
Bf	Brookings silty clay loam, 0 to 2 percent slopes	7.59	5.0%	I	95
BeB	Brandt silty clay loam, 2 to 6 percent slopes	3.80	2.5%	Ile	78
SrB	Strayhoss loam, 2 to 6 percent slopes	0.10	0.1%	Ile	67
Weighted Average					88.1